

Installation Instructions for Mercmaster™ III Luminaires

FOR PROPER AND SAFE INSTALLATION OF THIS PRODUCT, PLEASE READ THE FOLLOWING INSTRUCTIONS.

Applications

- Marine and wet locations;
- Areas where flammable gases and vapors or combustible dusts are present under conditions defined by the ratings below;
- Non-hazardous locations where severe weather conditions, excessive moisture, dirt, dust, corrosive atmospheres, or high ambient temperatures are encountered.

Ratings

- Class I, Division 2, Groups A, B, C, D
- Class II, Division 1, Groups E, F, G
- Class III
- Simultaneous Exposure (Class I, Division 2/Class II, Division 1)
- Type 3R
- Type 4X
- IP66
- Marine, Outside Type (Salt Water)

Product Safety

Signal Words Defined

DANGER indicates a hazardous situation which, if not avoided, will result in death or serious injury. **WARNING** indicates a hazardous situation which, if not avoided, could result in death or serious injury. **CAUTION** indicates a hazardous situation which, if not avoided, could result in minor or moderate injury. **NOTICE** is used to address practices not related to physical injury.

Safety Instructions

⚠ **WARNING:**

- Do not open or remove the luminaire with the circuit energized.
- Failure to ground this luminaire can result in an electric shock, which may be fatal.
- Do not use this luminaire on ungrounded circuits. Failure to ground the luminaire can result in an electric shock, which may be fatal.

⚠ **CAUTION:**

- When installing in a hazardous location, it is necessary that the globe be in place and that the unit be tightly closed.
- Luminaires with the optional photocontrol or quartz auxiliary lamp do not comply with UL requirements for use in classified locations.

⚠ **NOTICE:**

- This luminaire is designed for and should be installed in accordance with the National Electrical Code and all applicable local codes.
- The globe and reflector should be cleaned periodically to maintain lighting efficiency.
- Orient hinges and latches 90° from the aiming direction desired for the angle reflector. This applies to ceiling, wall, and stanchion mounting hoods.
- All unused conduit plugs and conduit runs must have pipe lubricant/sealant applied to the threads and then securely tightened. This will prevent water entry into the luminaire through the pipe threads. Use Appleton TLC-3 lubricant/sealant.

Mounting Hoods

Pendant (KPAF-75, KPAF-100, KPA-75, KPA-100)

Mounting:

1. Thread the pendant hood onto a 3/4 inch or 1 inch conduit stem. **NOTE:** A brace is required on conduit stems longer than 12 inches (NEC requirement).
2. Tighten the set screw inside the hood.

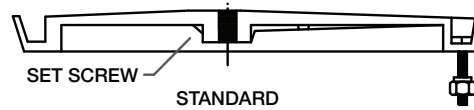
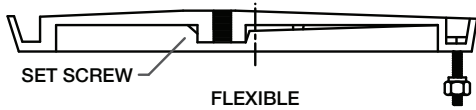

Pendant Cone (KPCH-75, KPCH-100)

Mounting:

1. Thread the pendant cone hood onto a 3/4 inch or 1 inch conduit stem. **NOTE:** A brace is required on conduit stems longer than 12 inches (NEC requirement).
2. Tighten the set screw outside the hood.

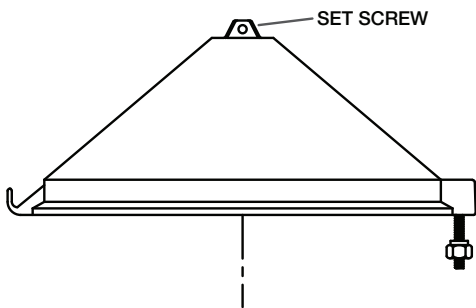

Ceiling (KPC-75, KPC-100)

Mounting:

1. Bolt the ceiling hood directly to a structural member; thread onto a 3/4 inch or 1 inch conduit stem; or bolt to a flush mounted junction box (see NOTES).
2. Remove unused conduit plugs and reinstall with pipe sealant.

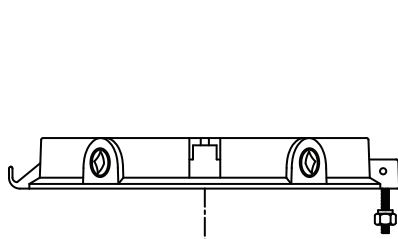

5 CONDUIT ENTRIES, 4 CONDUIT PLUGS

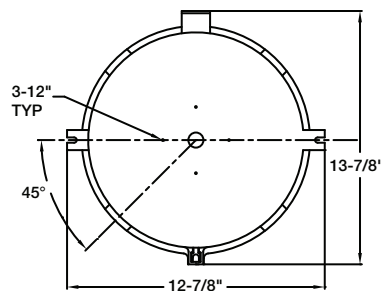

NOTES:

- Four drill marks on the 3-1/2 inch pitch diameter are provided for junction box mounting.
- Install the junction box gasket (supplied) between the junction box and the ceiling hood.

Wall (KPWB-75, KPWB-100)

Mounting:

1. Bolt the wall hood to a structural member.
2. Remove unused conduit plugs and reinstall with pipe sealant.

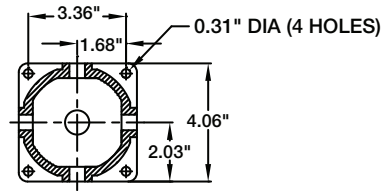
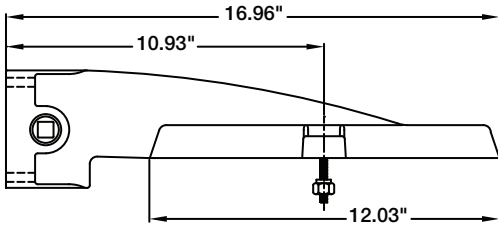

5 CONDUIT ENTRIES, 4 CONDUIT PLUGS

25° Stanchion (KPS-125, KPS-150)

Mounting:

1. Thread the stanchion hood onto a 1-1/4 inch or 1-1/2 inch conduit stem. **NOTE:** Five full threads must be engaged.
2. Determine the orientation and tighten the set screw.

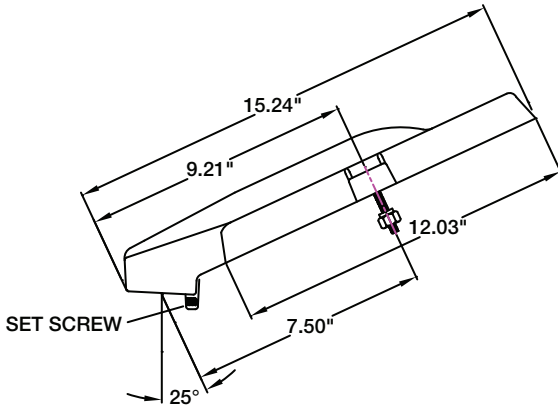

90° Stanchion (KPST-125, KPST-150)

Mounting:

1. Thread the stanchion hood onto a 1-1/4 inch or 1-1/2 inch conduit stem. **NOTE:** Five full threads must be engaged.
2. Determine the orientation and tighten the set screw.

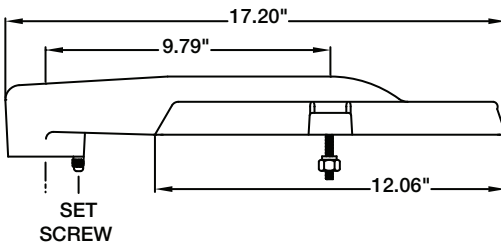

Installation

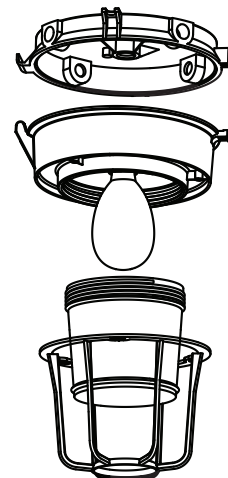
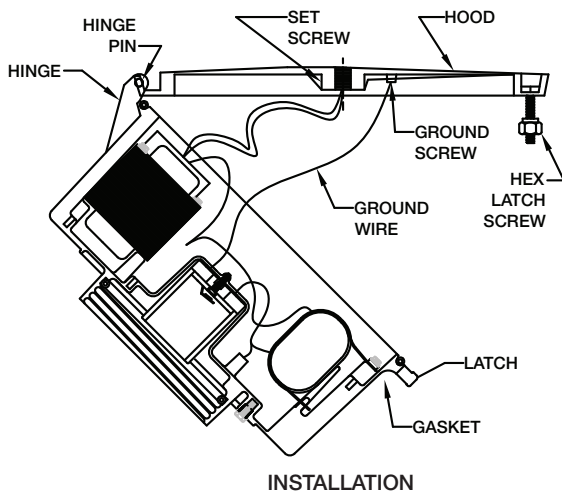

Installing & Wiring:

1. Feed the proper temperature supply wire into the mounting hood. See the product nameplate for supply wire requirements.
2. Hang the ballast housing on the hinge; secure with the hinge pin.
3. Connect the power to the proper ballast lead. See "Wiring Diagrams". **NOTE:** Leave all unused ballast leads capped (for multi-tap).
4. Connect the supply ground and housing ground leads to the GREEN ground screw on the mounting hood.
5. Fold all excess supply leads and fasten them into the mounting hood with the wire tie (supplied).
6. Swing the ballast housing up and tighten securely with the hex latch screw.
7. Install the lamp and tighten securely. Verify that the ANSI code of the ballast matches the installed lamp.
8. Install the globe or refractor and optional reflector and/or guard per the fixture label in the ballast housing. Make sure to hand-tighten the globe or refractor into the luminaire housing. After the globe or refractor contacts the gasket surface, tighten 1/4 to 1/2 turn with a strap wrench.

Optional Smart Hot Restrike

For 50 W–150 W HPS Only:

Luminaires may be equipped with a Smart Hot Restrike (designated by a -SR suffix), which will interrupt power to the lamp at the end of the lamp life. Smart Hot Restrike is a one-piece unit.

If the lamp does not start within 1–2 minutes of initial power application to the luminaire, the starter will open the secondary side of the circuit and will disconnect the power to the lamp. The starter can be reset by interrupting the main power supply to the luminaire for several seconds.

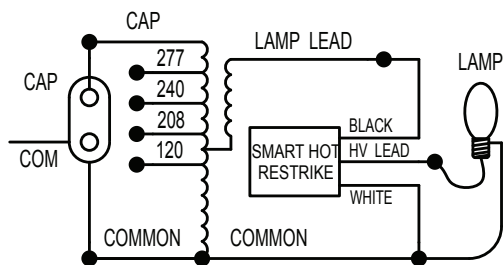

HSP MT (HX-HPF)

Wiring Diagrams

DUAL-TAP SUPPLY CONNECTION

GREEN GROUND TO MOUNTING HOOD
 277
 120
 WHITE SUPPLY LINE TO COMMON

MULTI-TAP SUPPLY CONNECTION

GREEN GROUND TO MOUNTING HOOD
 277
 240
 208
 120
 WHITE SUPPLY LINE TO COMMON

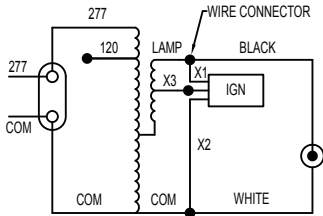

HPS DT (HX-HPF)

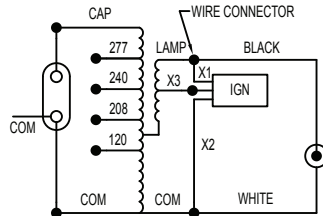

HPS MT (HX-HPF)

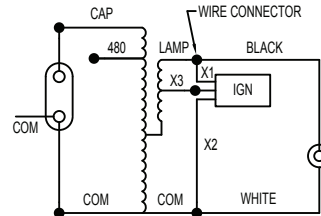

HPS 480V (HX-HPF)

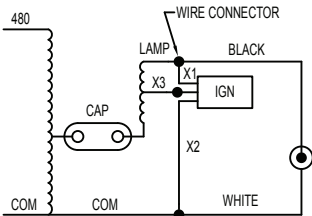

HPS 480V (CWA)

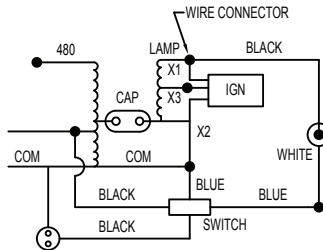

HPS 480V (CWA) QTZ

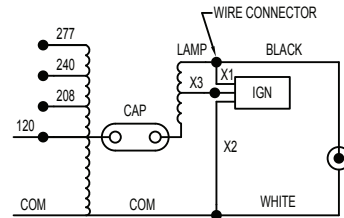

HPS MT (CWA)
PSMH MT (SUPER CWA)

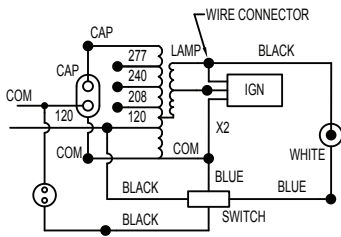

HPS MT (HX-HPF) QTZ

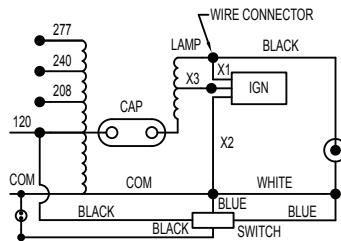

HPS MT (CWA) W/QTZ
PSMH MT (SUPER CWA) W/QTZ

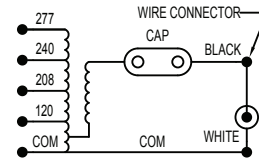

PSMH MULTI-TAP

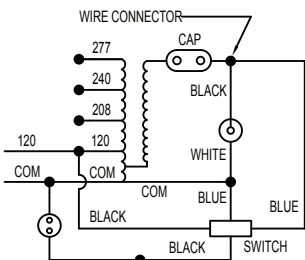

PSMH MT W/QTZ

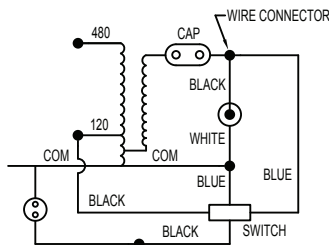

PSMH 480V W/QTZ

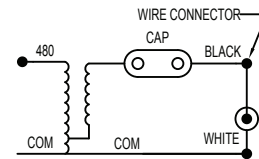

PSMH MULTI-TAP

Mercmaster III Family Tree & Parts List

Flexible Pendant Mount KPAF75 KPAF100

Pendant Mount KPA75 KPA100

Pendant Cone Mount KPCH75 KPCH100

Ceiling Mount KPC75 KPC100

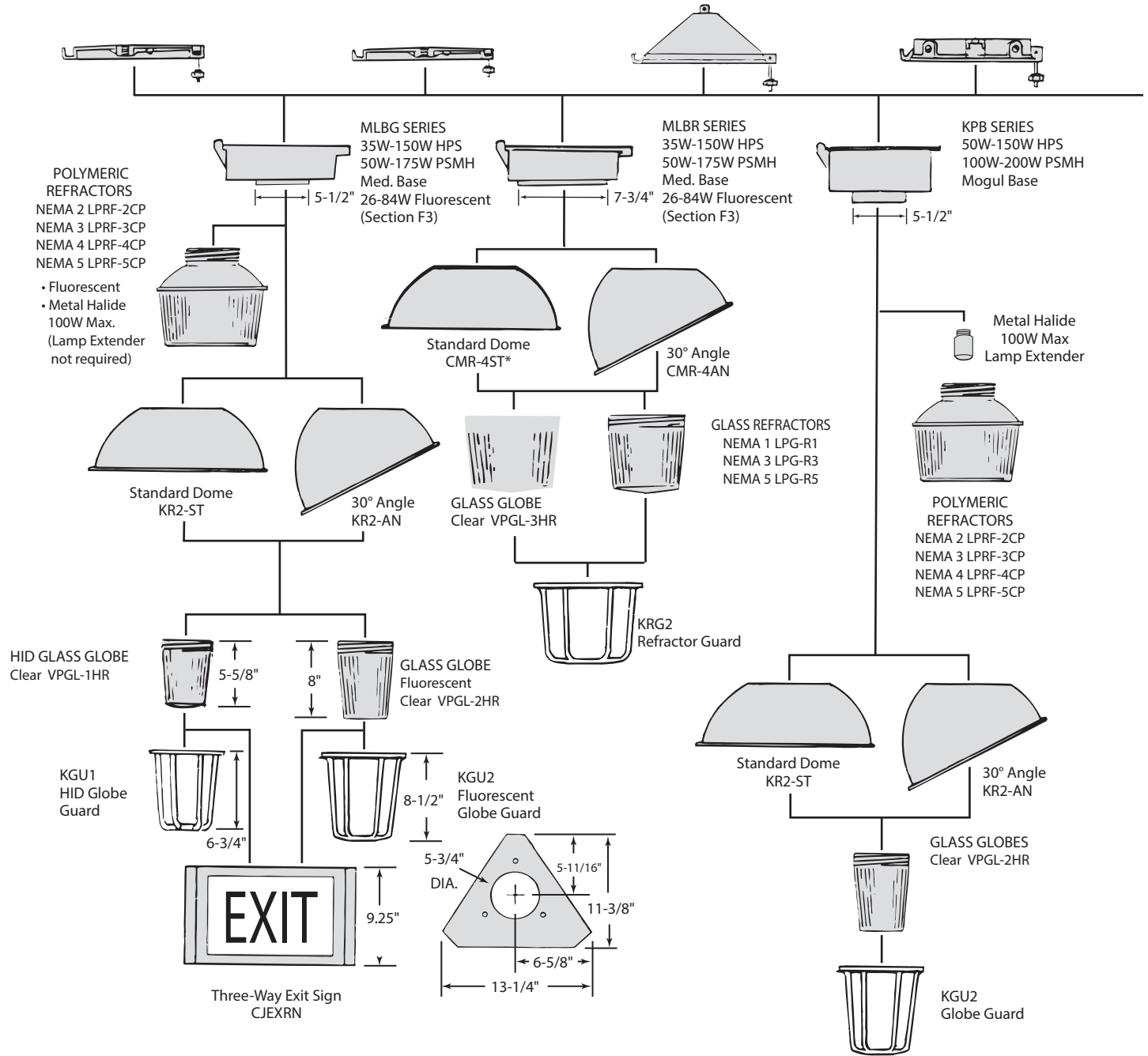

Mercmaster III Family Tree & Parts List

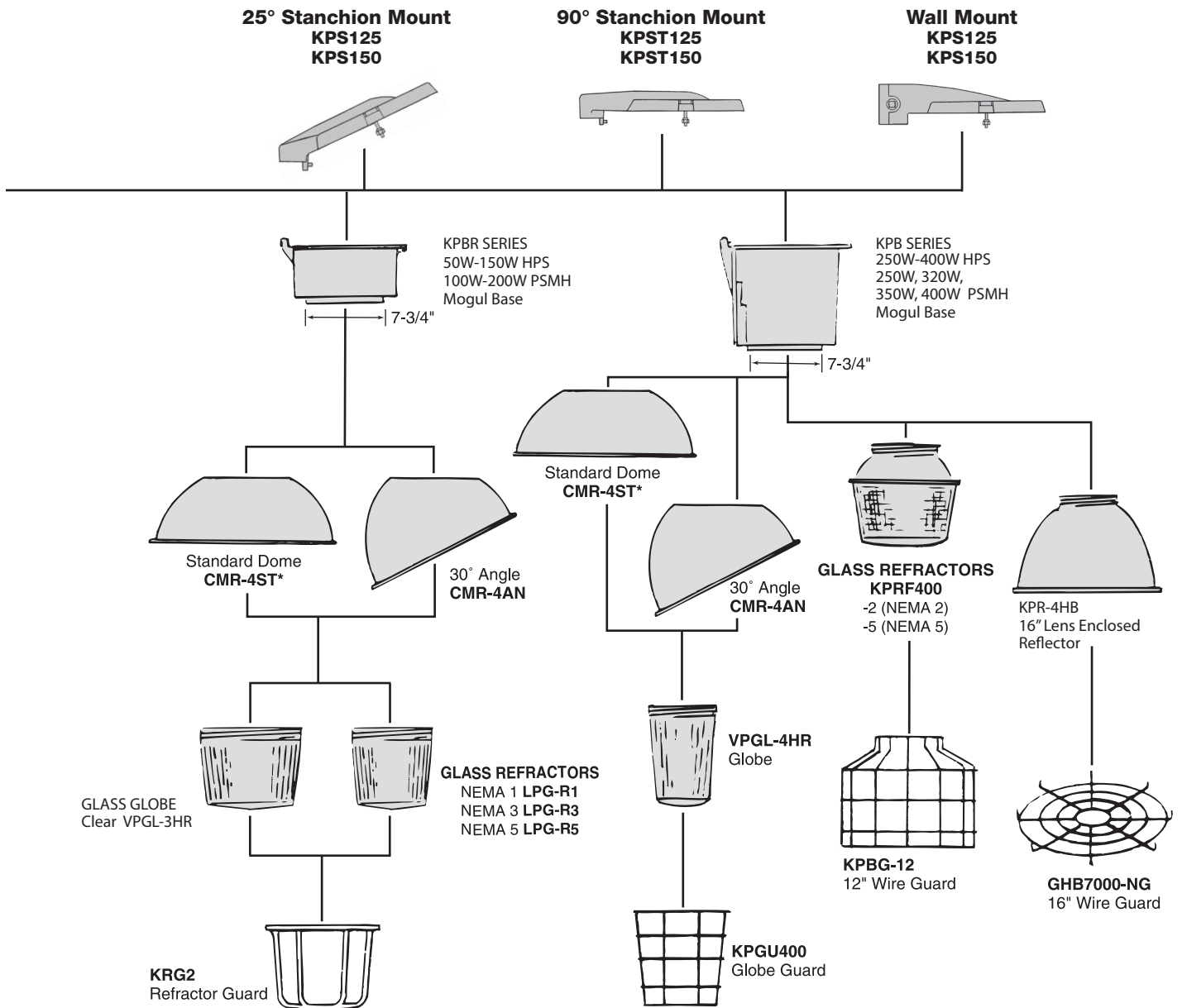

Except as expressly provided by Appleton Electric, LLC (Appleton), Appleton products are intended for ultimate purchase by industrial users and for operation by persons trained and experienced in the use and maintenance of this equipment and not for consumers or consumer use. Appleton warranties DO NOT extend to, and no reseller is authorized to extend Appleton's warranties to any consumer.

While every precaution has been taken to ensure accuracy and completeness in this manual, EGS Electrical Group, LLC, assumes no responsibility, and disclaims all liability for damages resulting from use of this information or for any errors or omissions. Specifications are subject to change without notice. The Appleton and Emerson logos are registered in the U.S. Patent and Trademark Office. All other product or service names are the property of their registered owners. ©2013 EGS Electrical Group, LLC. All rights reserved.