



# Diaphragm-Type Diaphragm Seals

## Flushing Ring Accessory

Type 910.27

### Diaphragm Seals

#### Application

Flushing ring is intended to be used with a flanged, pancake, or inline diaphragm seals. The flushing ring contains two lateral NPT ports to flush out the collected process medium adjacent to the diaphragm seal.

A flushing ring is excellent for use with diaphragm seal model numbers 990.27 and 990.28 when is a potential of the deposits from the process medium blocking access to the diaphragm seals. The flushing ring is designed to be sandwiched between the process flange and the diaphragm seal.

Material collected in front of the diaphragm can be flushed out through the flushing bore holes. The flushing ring can also been used to vent the process. Several standard widths and sizes are available to fit most process applications.



### Standard Features

#### Process Connection

2" to 4" per ASME B16.5

**Available Options** (connections, materials, etc.)

See Selection Guide (over)

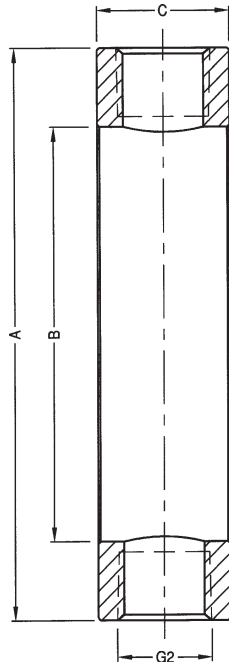

G2: PROCESS CONNECTION  
 CLASS=FLANGE RATING PER ASME B16.5  
 ALL DIMENSIONS IN INCHES UNLESS OTHERWISE NOTED

SIZE	G2	CLASS	A	B	C	WEIGHT
						lbs
2"	1/4"NPT OR 1/2"NPT	150# THROUGH 2500#	3.62	2.44	1.18	1.3
3"			5.00	3.62		2.3
4"			6.18	3.62		6.3
5"			7.30	4.96		7.3

DWG.#2212307-5

To determine the effects of temperature and response time in a specific application, contact the factory for an **Application Questionnaire**. The information provided will allow WIKA Technical Support to accurately model your application parameters using state-of-the-art computer simulation techniques.

**ACS 910.27**  
 (ACS 91.05)

# Selection Guide - Type 910.27

910.27,2.0,-RF,2X1/4F,SS

**Material**

SS = 316 stainless steel  
 HC = Hastelloy® C-276  
 HB = Hastelloy® B-2  
 MO = Monel® 400  
 NI = Nickel 200  
 TI = Titanium, grade 2

**Flushing Port**

1/4F = 1/4" NPT female  
 1/2F = 1/2" NPT female (See note 1)  
 G1/4 = G1/4  
 G1/2 = G1/2 (See note 1)

**Number of Flushing Ports**

1 = One flushing port  
 2 = Two flushing ports

**Sealing Face**

-RF = Raised face (250 RMS)  
 RTJ = Ring joint  
 125 = Raised face (125 RMS)  
 DIN = DIN 2526 form D  
 XXX = Other (Customer to define sealing face on purchase order)

**Piping Size**

Sealing face per ASME B16.5  
 1.0 = 1" pipe  
 1.5 = 1.5" pipe  
**2.0 = 2" pipe**  
**3.0 = 3" pipe**  
**4.0 = 4" pipe**  
 5.0 = 5" pipe

Sealing face per DIN  
 025 = DN25  
 032 = DN32  
 040 = DN40  
 050 = DN50  
 080 = DN80  
 100 = DN100  
 125 = DN125

**Accessory Type**

910.27 = Flushing ring

**Notes**

1. Available on 2" and larger pipe sizes.

Options not listed may be available, please consult factory.  
 Fill Fluid & Mounting options: Please reference data sheet ACS 99.MO.

THE MEASURE OF  
**Total Performance™**

**Ordering Information:**

State computer part number (if available) / type number / size / range / connection size and location / options required.

Specifications given in this price list represent the state of engineering at the time of printing.  
 Modifications may take place and the specified materials may change without prior notice



**WIKAI Instrument Corporation**

1000 Wiegand Boulevard  
 Lawrenceville, Georgia 30043-5868  
 Tel: 770-513-8200 Fax: 770-338-5118  
<http://www.wika.com> e-mail: [diaphragmseal@wika.com](mailto:diaphragmseal@wika.com)